

# LAND FOR SALE

# FOX FIELD

Mineral Spring Avenue  
North Providence, RI

## 5 ACRE UNDEVELOPED LOT AVAILABLE IMMEDIATELY

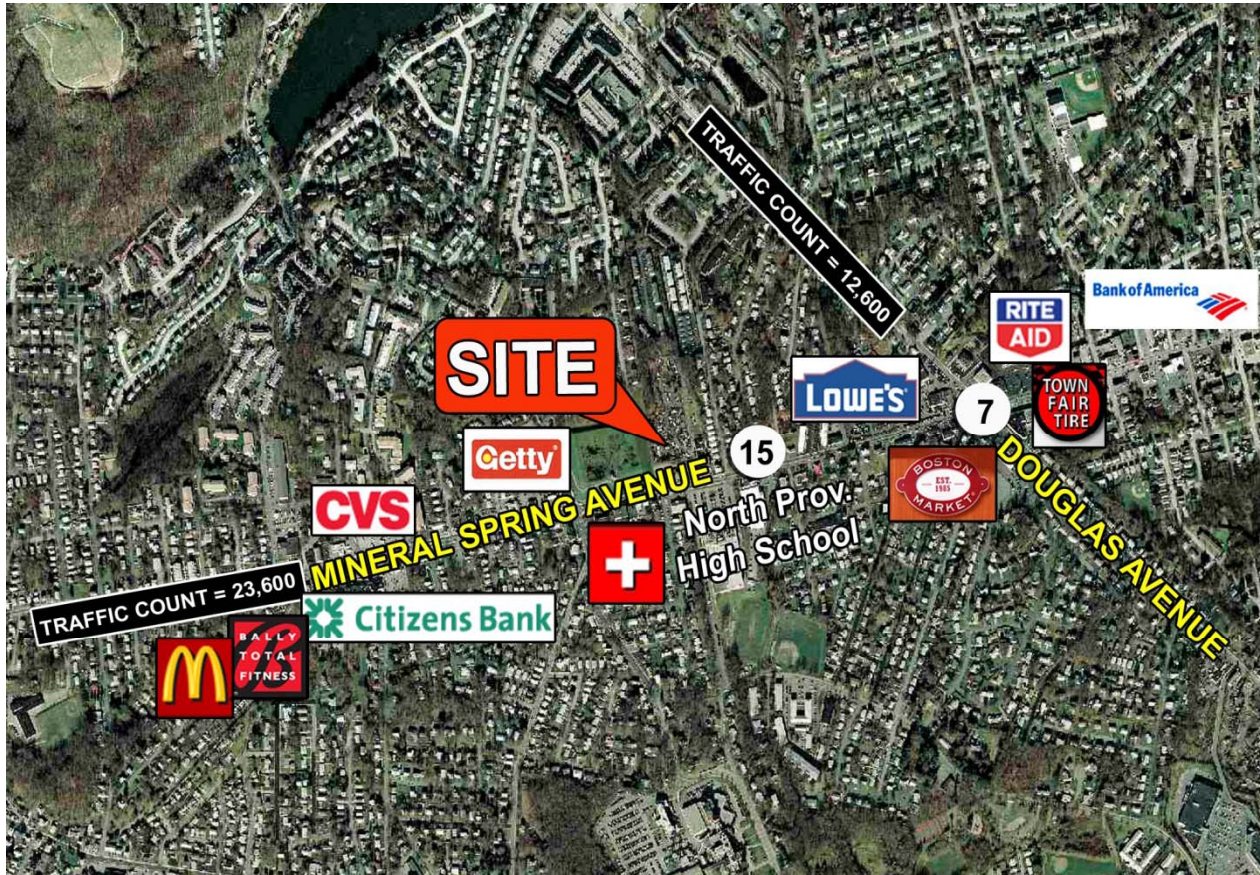

<b>PREMISES</b>	5 acre parcel
<b>ZONE</b>	Commercial
<b>COMMENTS</b>	The formerly proposed 40,000 SF development did not include two parcels totaling +/-15,735 Sf of land and building with frontage along Mineral Spring Avenue. The owner of the parcels will consider selling

<b>DEMOGRAPHICS</b>	POP	HH INCOME
<b>1 MILES</b>	16,498	\$50,142
<b>2 MILES</b>	55,657	\$49,527
<b>3 MILES</b>	125,013	\$44,836

### DEVELOPMENT FEATURES

- 40,000 SF COMMERCIAL DEVELOPMENT
- LOCATED OFF MINERAL SPRING AVENUE
- BETWEEN PLYMPTON & PIERCE STREETS
- REDEVELOPMENT OPTIONS AVAILABLE
- POSSIBLE ASSEMBLAGE OF ADJACENT LOTS
- COMPREHENSIVE BID PACKAGE AVAILABLE
- SITE VISITS ARE AVAILABLE

### FOR MORE INFORMATION, PLEASE CONTACT:

**Pete Hayes**  
Partner  
(401) 273-7426  
[phayes@hayessherry.com](mailto:phayes@hayessherry.com)

### Hayes & Sherry Real Estate Services

146 Westminister Street, 2<sup>nd</sup> Floor  
Providence, RI 02903  
(401) 273-1980  
[www.hayessherry.com](http://www.hayessherry.com)

Information set forth is from sources we deem reliable. This property is offered subject to prior sale, lease or withdrawal without notice or change in prices and conditions.





# FOX FIELD

Mineral Spring Avenue  
North Providence, RI

## LAND FOR SALE

## 5 ACRE UNDEVELOPED LOT AVAILABLE IMMEDIATELY

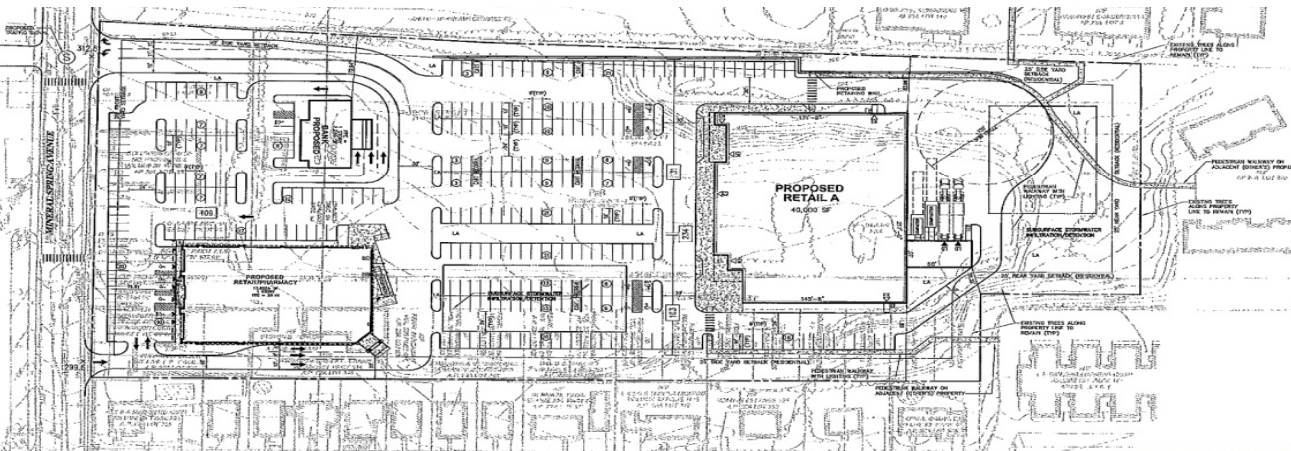
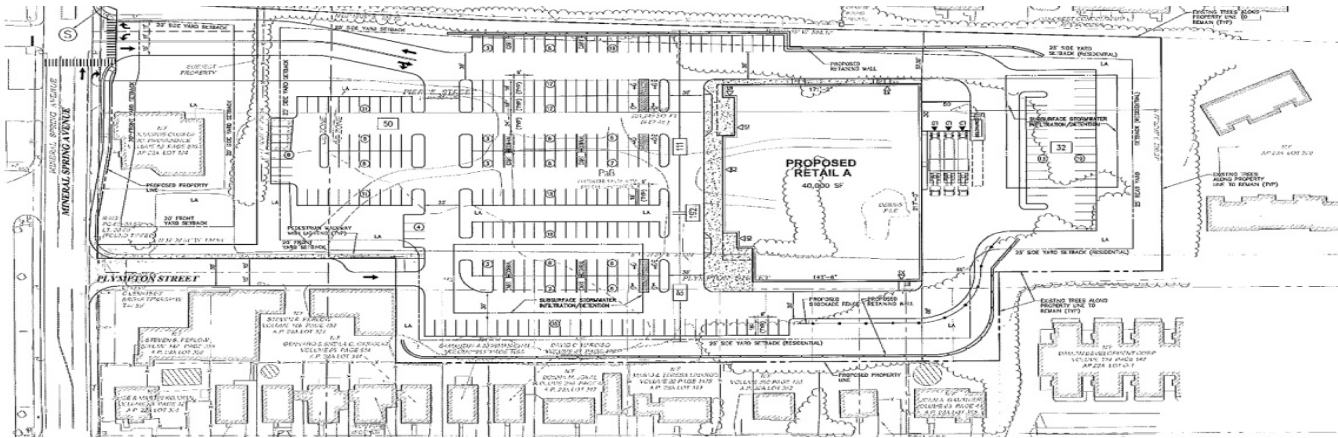

**FOR MORE INFORMATION, PLEASE CONTACT:**

**Pete Hayes**

Partner

(401) 273-7426

[phayes@hayessherry.com](mailto:phayes@hayessherry.com)

**Hayes & Sherry Real Estate Services**

146 Westminster Street, 2<sup>nd</sup> Floor

Providence, RI 02903

(401) 273-1980

[www.hayessherry.com](http://www.hayessherry.com)

Information set forth is from sources we deem reliable. This property is offered subject to prior sale, lease or withdrawal without notice or change in prices and conditions.

